

## DESCRIPTION

The Downhill Dan 10 extrusion is our most compact profile. At only 10mm deep, it's ideal for tight spaces and minimal visual impact. Downhill Dan 10 can be surface mounted, recessed or suspended. Both wire and rod suspension options are available for the Downhill Dan 10 extrusion. Downhill Dan 10 can be cut and joined to create any length required.

## FEATURES

- Made locally and factory assembled
- Unique mounting clip design for easy installation
- V-groove for accurate drilling and strip alignment
- Polycarbonate diffuser - UV resistant
- Straight joiners and L-plates
- Max. 14 W recessed | 20 W surface-mounted

## TECHNICAL DATA

APPLICATIONS	Task lighting in kitchen cabinetry, shelving or display units, concealed architectural details
INSTALLATION	Interior   Exterior (with IP65 LED strip)
MOUNTING	Surface mounted   Recessed
MATERIALS	Extruded aluminium body   Polycarbonate diffuser   AES plastic end caps
LIGHT SOURCE	LED ribbon strip
POWER SUPPLY	24V DC - remote driver options ranging from 6 W up to 320 W
DIMMABLE	DALI, 1-10V, Phase Cut and Bluetooth drivers available
WARRANTY	7 year product warranty   13 months labour warranty. Refer to <a href="http://www.lightculture.com.au">www.lightculture.com.au</a> for more details

## FINISH



\*Custom colours available



## LED STRIP

### PRO Series IP20 & IP65

6 W/m			12 W/m			18 W/m			30 W/m - IP20 only		
2700 K	3000 K	4000 K	2700 K	3000 K	4000 K	2700 K	3000 K	4000 K	2700 K	3000 K	4000 K
255 lm	255 lm	255 lm	529 lm	529 lm	568 lm	784 lm	833 lm	843 lm	-	-	-

### RGBW IP20 & IP65

22 W/m			
RED	GREEN	BLUE	3000K
51 lm	135 lm	33 lm	197 lm

The above outputs are quoting luminaire output lumens per metre  
 30 W/m strip only available in IP20.  
 IP65 strips are +/- 200 K in colour temperature variance due to the silicone coating.  
 Electrical and optical data variance +/- 10%

## ACCESSORIES



JN-ST  
Straight joiner



JN-90  
90 degree joiner

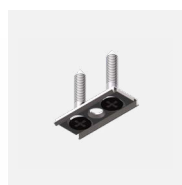

JMC-12  
Joinery mounting clip

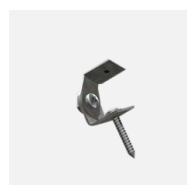

MB-ADJ  
Adjustable mounting bracket

