

MOUNTING INSTRUCTIONS - LIVENTY LED

LIVENTY 600x600, 1200x300

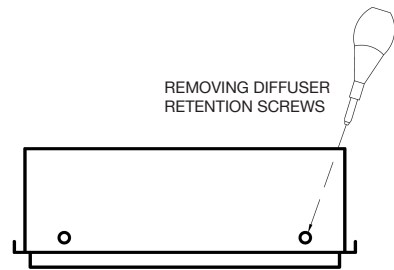

1. MOUNTING GUIDANCE



PLEASE NOTE

- FIXTURE MUST BE SWITCHED OFF BEFORE DIFFUSER IS REMOVED/REPLACED. DO NOT TOUCH LEDS OR BOARDS AT ANY TIME
- REMOVE ALL 4 DIFFUSER RETENTION SCREWS BEFORE DETACHING OR ADJUSTING DIFFUSER
- DIFFUSER RETENTION SCREWS MUST BE REPLACED AFTER DIFFUSER INSERTION
- DIFFUSER OF LIVENTY FLAT AND LIVENTY MUST BE REMOVED ONLY WITH THE SUCTION TOOL PROVIDED

Type	ca. kg
Liventy 600 OT LED...	5.1
LiventyAct 600 OT LED...	5.8
Liventy Flat 600 OT LED...	5.0
LiventyAct Flat 600 OT LED...	5.8

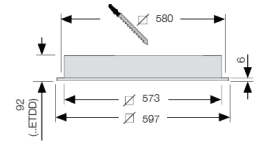

Type	ca. kg
Liventy Flat 300 LED...	4.9

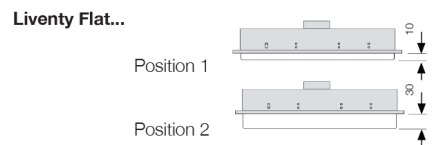
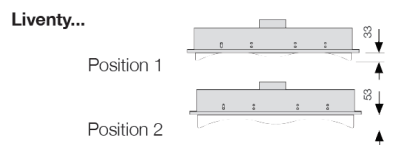
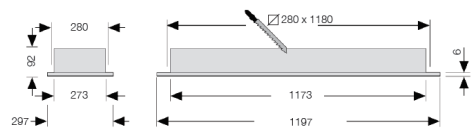

Type	ca. kg
Liventy Flat 300 LED...	4.9

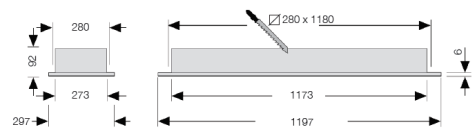

NOTES

INTENDED USE

THE LIVENTY... LED LUMINAIRE IS INTENDED FOR INSTALLATION IN SUSPENDED CEILING INDOOR ROOMS AT AMBIENT OF TA 25°C
 THE LIVENTY... LED LUMINAIRE IS INTENDED FOR INSTALLATION OUT OF ARM'S REACH

SAFETY NOTES

THESE INSTRUCTIONS ASSUME EXPERT KNOWLEDGE CORRESPONDING TO A COMPLETED PROFESSIONAL EDUCATION AS AN ELECTRICIAN

- NEVER WORK WHEN VOLTAGE IS PRESENT ON THE LUMINAIRE. CAUTION - RISK OF FATAL INJURY
- LED CLASS 1
- POWER SUPPLY FOR BRIGHTNESS CONTROL IF EXISTING MUST COMPLY WITH SELV REQUIREMENTS
- IN CASE OF MALFUNCTIONS WITH THE LED MODULE, PLEASE CONTACT **LIGHT CULTURE**
- DO NOT COVER THE LUMINAIRE **LIVENTY..LED** WITH INSULATING MATERIAL



IMPORTANT INFORMATION REGARDING ELECTRONIC CONTROL GEAR (ECG)

- INTERFERENCE TO THE NEUTRAL CONDUCTOR IN A THREE-PHASE SYSTEM MAY RESULT IN SURGE-RELATED DAMAGE IN THE LIGHTING INSTALLATION. ONLY OPEN NEUTRAL CONDUCTOR - DISCONNECT TERMINAL WHEN DISCONNECTED FROM SUPPLY AND CLOSE PRIOR TO SWITCHING BACK ON
- THE MAXIMUM ADMISSIBLE AMBIENT TEMPERATURE t_a OF THE LUMINAIRE MAY NOT BE EXCEEDED. SURPASSING THAT TEMPERATURE REDUCES THE SERVICE LIFE AND, IN EXTREME CASES, POSES RISK OF EARLY FAILURE
- USE MAINS CABLES FOR CONTROL INPUTS OF DIMMABLE ECG (1...10V, DALI, ETC.) WHICH ARE RATED FOR 230V

Detach the diffuser / adjust the diffuser

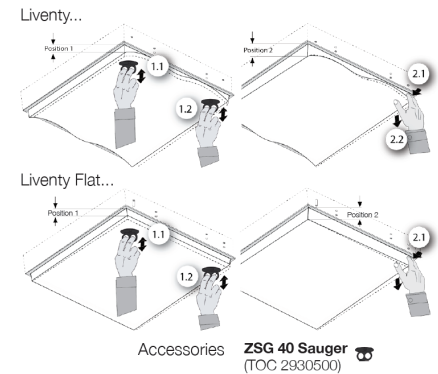

Detach the diffuser

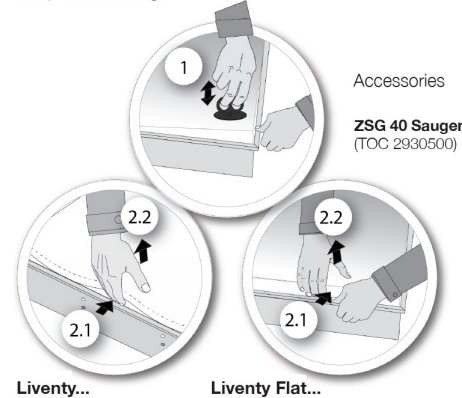

MAKE SURE THAT THE DIFFUSER NOTCHES ARE ALIGNED IDENTICALLY TO THE CORRESPONDING PERFORATIONS IN THE LUMINAIRE BODY

TRILUX RECOMMENDS THAT YOU STORE THE DIFFUSER TEMPORARILY IN A CLEAN PLACE WHILE YOU ARE DOING MOUNTING WORK

