

NEON CRYSTAL | SINGLE COLOUR

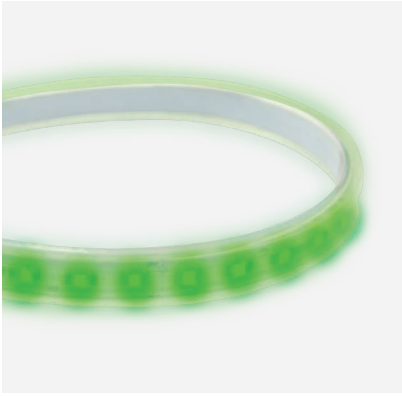

COLOUR	CODE
RED 615 - 625 nm	BL-LS-5000-R
GREEN 520 - 530 nm	BL-LS-5000-G
BLUE 465 - 475 nm	BL-LS-5000-B
AMBER 588-594 nm	BL-LS-5000-A

ELECTRICAL & OPTICAL DATA VARIANCE +/- 10%
SOLD BY THE METRE
IES FILES AVAILABLE

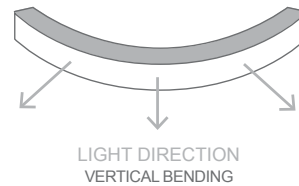
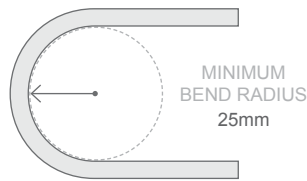
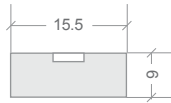

TECHNICAL DATA

LED WATTS	12 W/m (G B) 8 W/m (R, A)	LED QTY	72	CUTTING LENGTH	83.3 mm (G,B) 125 mm (R,A)
INPUT VOLTS	24 V DC constant voltage	SOURCE LIFE	50,000 hrs	HOUSING	UV and flame resistant clear PVC
OPERATING TEMP	- 20 °C ~ + 45 °C	WARRANTY	5 years	CONTROL	Dimmable by PWM signal
LUMENS	R ≥ 220 lm/m G ≥ 550 lm/m B ≥ 110 lm/m Y ≥ 220 lm/m	MIN BEND RADIUS	25 mm	MAX. RUN PER FEED	10 m (G B) or 15 m (R, A) using one feed 20 m (G B) or 30 m (R,A) using two feeds
BEAM ANGLE	120°	BEND DIRECTION	Vertical bending	MOUNTING	See Installation Guide for mounting accessories
LED PITCH	13.8 mm	DIMENSIONS	15.5 mm x 6 mm		
		INGRESS PROTECTION	IP65 or IP67 Protection established by use of connection type See Installation Guide for connections		

APPLICATION

- Creative colour installation
- Theatres, bars, restaurants, retail
- Cove lighting, handrails, or toekicks
- Architectural features
- Exterior or interior installations
- Swimming or feature pools

FEATURES

- A clear PVC allows maximum light output
- UV and flame resistant
- Suitable for use around salt or chlorinated water